

AES-256-CBC encryption

This command is for block cipher encryption using AES-256-CBC.

The encryption key is only a password key.

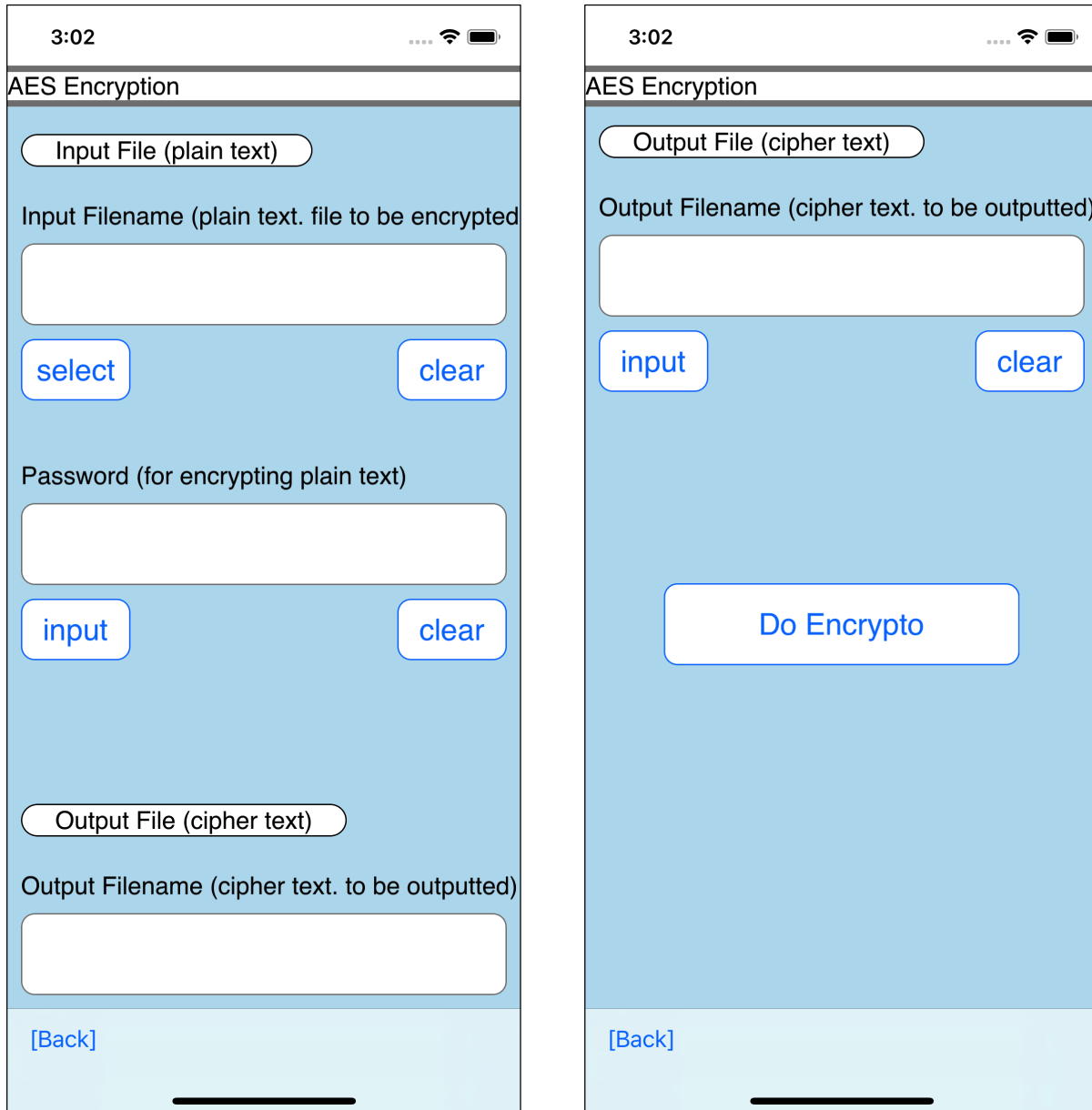

The user interface looks like this.

Encryption target file name

Encryption password

Cipher text output destination file name

This is the meaning.

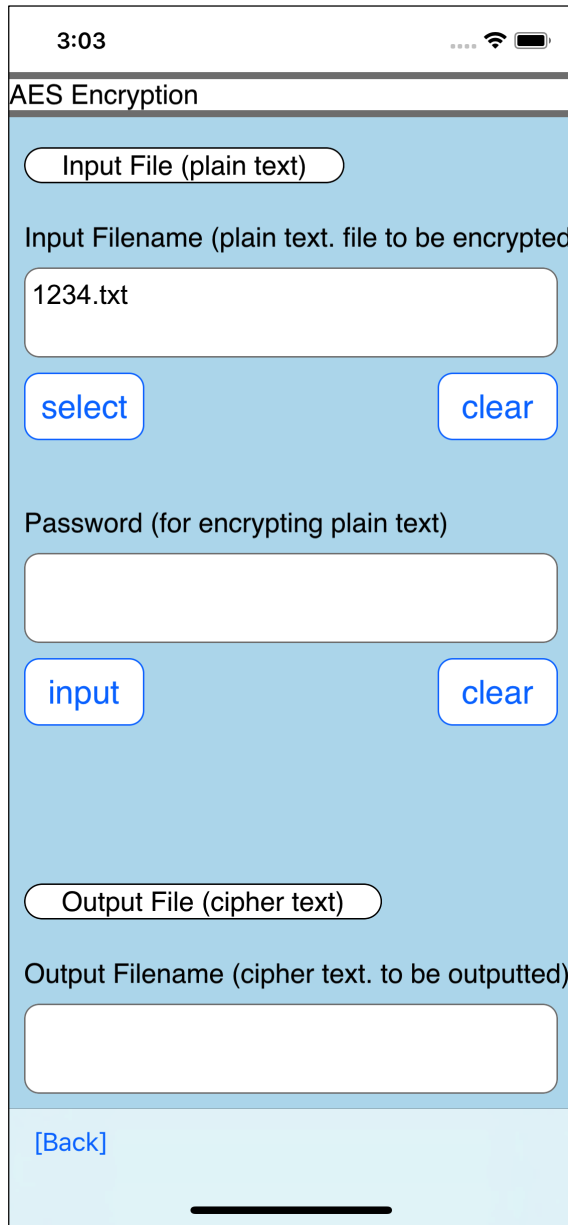
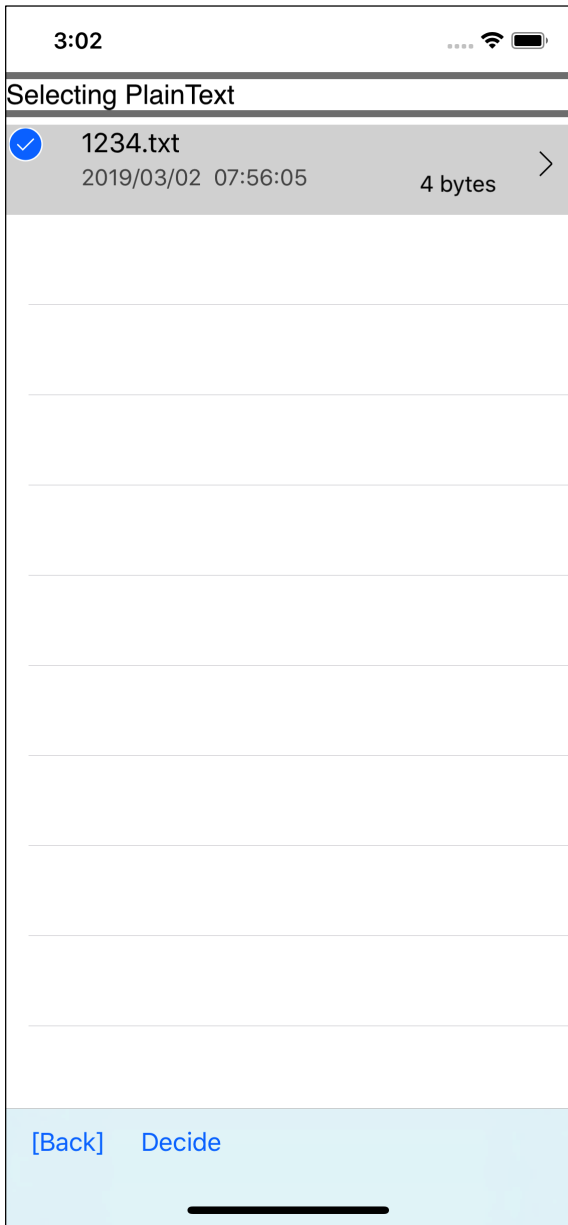

3:03

Inputting a Password for encrypting PlainText

Password (max. 299)

Aaaa

[Cancel] Decide

3:03

AES Encryption

Input File (plain text)

Input Filename (plain text. file to be encrypted)

1234.txt

select clear

Password (for encrypting plain text)

Aaaa

input clear

Output File (cipher text)

Output Filename (cipher text. to be outputted)

[Back]

